

Notes

1. Do not scale
2. Dimensions are in millimetres unless stated otherwise

Contains Ordnance Survey data ©
 Crown copyright and database right
 2023 Folkestone & Hythe District
 Council 100019677

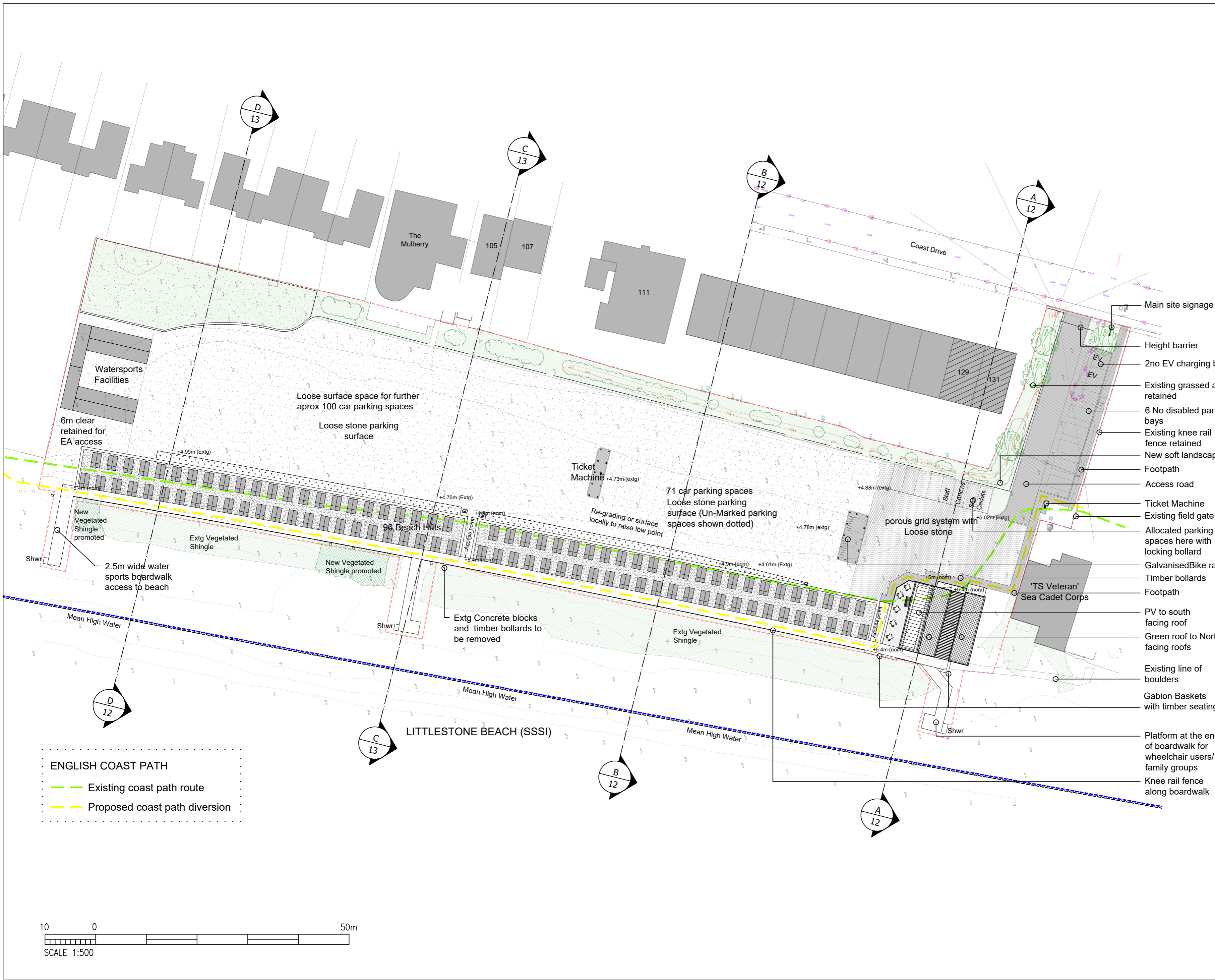

- Main site signage
- Height barrier
- 2no EV charging bays
- Existing grassed area retained
- 6 No disabled parking bays
- Existing knee rail fence retained
- New soft landscaping
- Footpath
- Access road
- Ticket Machine
- Existing field gate
- Allocated parking spaces here with locking bollard
- Galvanised Bike racks
- Timber bollards
- Footpath
- PV to south facing roof
- Green roof to North facing roofs
- Existing line of boulders
- Gabion Baskets with timber seating
- Platform at the end of boardwalk for wheelchair users/family groups
- Knee rail fence along boardwalk

REV	DESCRIPTION	DATE	BY	CHKD
K	Proposed Coastal Walk route updated	14/09/2023	LMK	
J	Lanscaping updated to reflect landscape plans	13/07/2023	LMK	
I	Un-Marked parking spaces shown, levels added, additional sect refs shown	06/06/2023	LMK	
H	Extg Stones & Posts shown removed	25/05/2023	LMK	
G	Level information added	May 23	LMK	
F	Beach hut numbers reduced, Visitor centre updated	Nov 22	BW	
	Surfacing updated, access points reduced			
	Footpath Added			

Folkestone & Hythe District Council
 Strategic Development Projects,
 Civic Centre, Castle Hill Avenue
 Folkestone, Kent, CT20 2QY
 Tel: 01303 853000
 Fax: 01303 853333

Project **Coast Drive Car Park
 Greatstone, TN28 8NR
 Proposed Visitor hub & beach huts**

Drawing Title
Proposed site / Blockplan

ORIGINAL DRAWING SIZE A2

Drawn: BW / LMK	Checked:	Date: May 2023
Scale 1:500	Drawing Number 0666-02	Rev K

- ENGLISH COAST PATH**
- Existing coast path route
 - Proposed coast path diversion

